

Spectacle Blinds

TYPE F

MACHINE FINISH

150#, 300#, 400#, 600#,
900# & 1500# RF

Serrated machine finish is standard.
Smooth machined can be furnished.

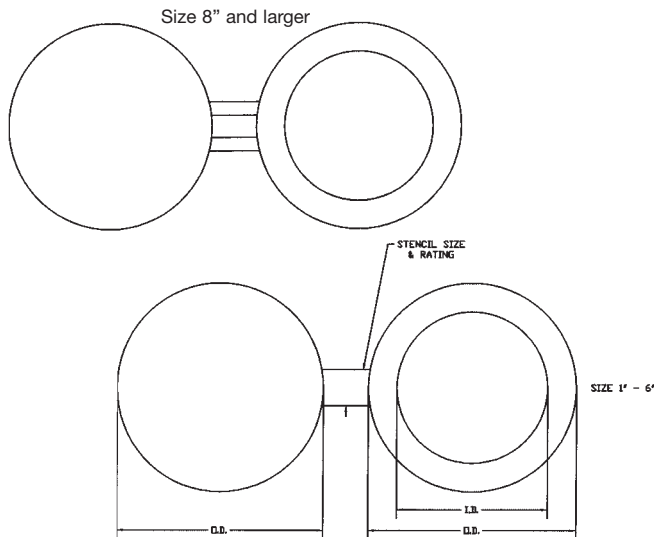

TYPE 8 F
Spectacle/figure 8 blind
Machine Finish

TYPE M

SMOOTH MILL FINISH

(Not machined)

Recommended Limitation

1" thru 12" 150# and 300# R.F. and F.F.

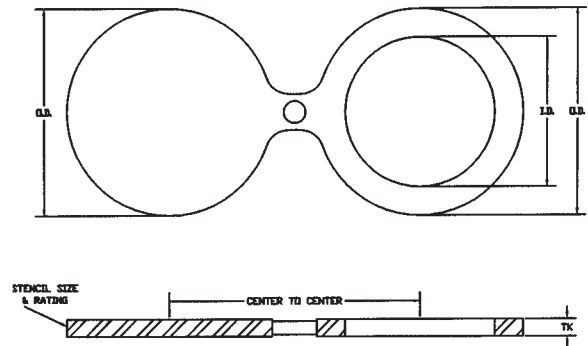

TYPE 8 M
Spectacle/figure 8 blind
Mill Finish

300 #, 400 #, 600 #, 900 #, 1500 #, 2500 # Ring Type Joint

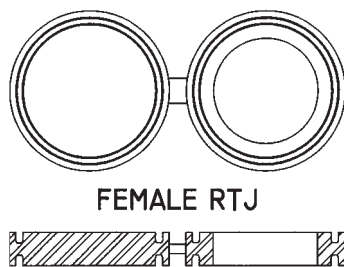

TYPE 8
Female octagonal - standard

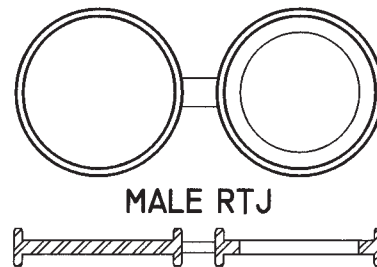

TYPE 8
Male octagonal

HOW TO ORDER

1. Quantity
2. Line size
3. Flange rating
4. Flange facing
5. WeamcoMetric type
6. Finish
7. Material
8. For RTJ and/or high pressure blinds advise design pressure and temperature, or thickness required.

See back of
Bulletin for
Dimensions.



(918) 445-1141

(800) 331-3790

Fax: (918) 445-4617

www.weamco.com

Bulletin LB303

Paddle Blinds & Spacer Rings

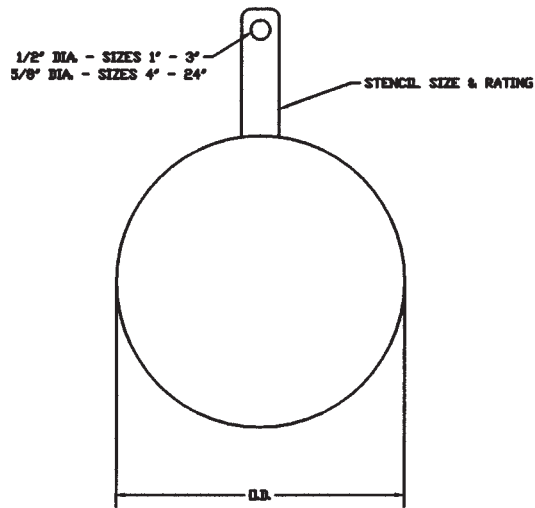

TYPE 2 F
Paddle Blind
Machine Finish

TYPE 2 M
Paddle Blind
Mill Finish

**TYPE 2 and TYPE 4 also Available
in Male and Female RTJ.**

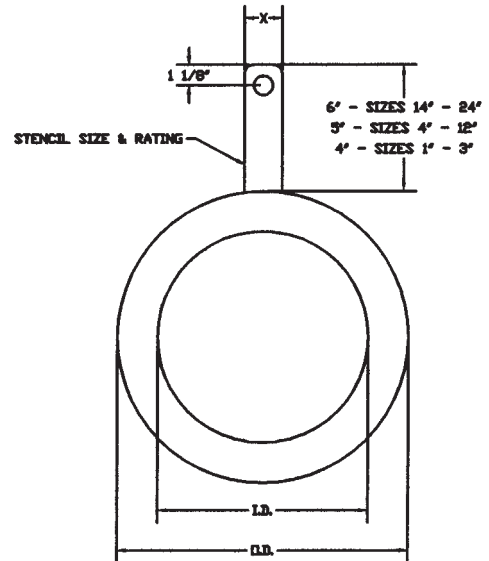

TYPE 4 F
Spacer Ring
Machine Finish

TYPE 4 M
Spacer Ring
Mill Finish

RAISED FACE OR FLAT FACE (IN INCHES)													
LINE SIZE	ID	150#		300#		400#		600#		900#		1500#	
		OD	TK*	OD	TK*	OD	TK*	OD	TK*	OD	TK*	OD	TK*
1	1 1/8	2 1/2	1/4	2 3/4	1/4	2 3/4	1/4	2 3/4	1/4	3	1/4	3	5/16
1 1/2	1 3/4	3 1/4	1/4	3 5/8	1/4	3 5/8	1/4	3 5/8	1/4	3 3/4	5/16	3 3/4	3/8
2	2 1/4	4	1/4	4 1/4	1/4	4 1/4	1/4	4 1/4	5/16	5 1/2	3/8	5 1/2	1/2
3	3 1/4	5 1/4	1/4	5 3/4	3/8	5 3/4	3/8	5 3/4	7/16	6 1/2	9/16	6 3/4	11/16
4	4 1/4	6 3/4	1/4	7	1/2	6 7/8	1/2	7 1/2	9/16	8	11/16	8 1/8	7/8
6	6 1/4	8 5/8	3/8	9 3/4	5/8	9 5/8	5/8	10 3/8	13/16	11 1/4	1	11	1 7/16
8	8 1/4	10 7/8	1/2	12	3/4	11 7/8	7/8	12 1/2	1 1/16	14	1 5/16	13 3/4	1 11/16
10	10 1/4	13 1/4	5/8	14 1/8	1	14	1 1/16	15 5/8	1 3/16	17	1 5/8	17	**
12	12 1/4	16	3/4	16 1/4	1 1/8	16 3/8	1 1/4	17 7/8	1 9/16	19 1/2	1 15/16	20 3/8	**
14	14	17 1/2	3/4	19	1 1/4	18 7/8	1 7/16	19 1/4	1 3/4	20 3/8	**	-	-
16	16	20	7/8	21 1/8	1 3/8	21	1 5/8	22 1/8	**	22 1/2	**	-	-
18	18	21 1/2	1	23 3/8	1 9/16	23 1/4	1 13/16	24	**	25	**	-	-
20	20	23 3/4	1 1/16	25 5/8	1 3/4	25 3/8	**	26 3/4	**	27 3/8	**	-	-
24	24	28 1/8	1 5/16	30 3/8	**	30 1/8	**	31	**	32 7/8	**	-	-

* NOTE: THICKNESS SHOWN ABOVE IS FOR CARBON STEEL 30 ksi MINIMUM YIELD STRENGTH

** THICKNESS NOT SHOWN IS DEPENDENT UPON TYPE OF MATERIAL SELECTED

MATERIALS & SPECIFICATIONS

- Standard material: Carbon Steel ASTM A 36 or A 516 Gr 70. Almost any other steel, stainless steel or alloy steel can be supplied.
- Carbon steel rings have one coat of shop primer.
- Alloy blinds have carbon steel tie bar or handle unless otherwise specified.
- Thickness shown is based upon ANSI Code B31.3-1987. OD, ID & RJ dimensions to fit flanges manufactured in accordance with ANSI B16.5.
- ID and OD are flame cut.
- Tolerances: ID and OD +/- 1/8". Thickness +/- 1/16". C-C +/- 1/4.
- Line Blanks can be furnished to API Standard 590.
- For special sizes and types not shown please consult the factory.



(918) 445-1141

(800) 331-3790

Fax: (918) 445-4617

www.weamco.com

Bulletin LB303

Large Diameter Paddle Blinds & Spacer Rings

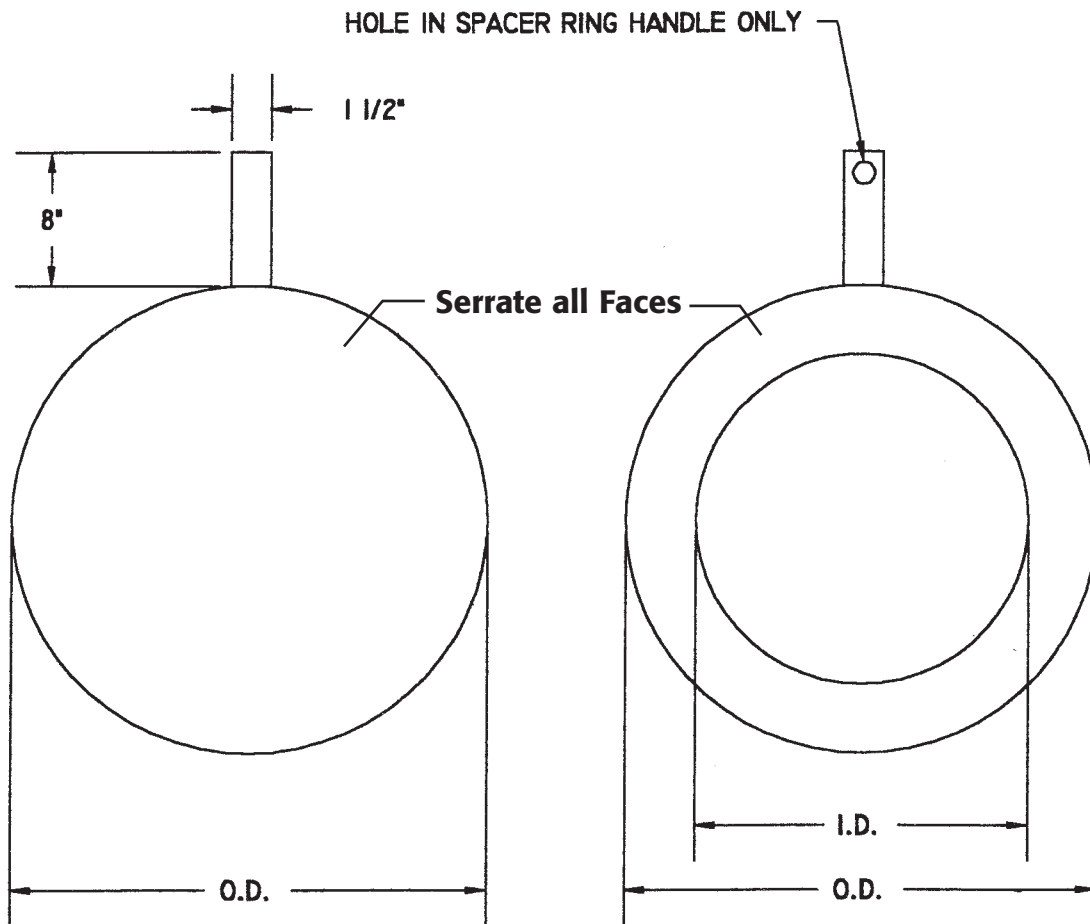

SIZE	150#			300#			600#			900#			1500#		
	TK*	ID	OD	TK*	ID	OD	TK*	ID	OD	TK*	ID	OD	TK*	ID	OD
24	1 1/4	24	27 5/8	2	24	29 7/8	2 7/8	23 1/2	30 1/2	3	23 1/2	32 3/8	4 3/8	22 5/8	34 7/8
26	1 1/4	26	29 7/8	2 1/8	26	32 1/4	2 7/8	25 1/2	33 1/2	3 1/2	25 1/2	34 1/8	4 1/2	24 1/2	NOTE 3
28	1 3/8	28	32 1/8	2 1/4	28	34 3/4	3 1/8	27 1/2	35 3/8	3 3/4	27 1/2	36 5/8	4 7/8	26 1/2	NOTE 3
30	1 1/2	30	34 1/8	2 3/8	30	36 7/8	3 3/8	29 1/2	37 5/8	4 1/8	29 1/2	39 1/8	5 1/4	28 1/2	NOTE 3
32	1 5/8	32	36 3/8	2 1/2	32	39	3 1/2	31 1/2	39 5/8	4 3/8	31 1/2	41 5/8	5 5/8	30 1/2	NOTE 3
34	1 3/4	34	38 3/8	2 5/8	34	41	3 3/4	33 1/2	41 5/8	4 5/8	33 1/2	44 1/8	5 7/8	32 1/2	NOTE 3
36	1 3/4	36	40 5/8	2 7/8	36	43 3/8	4	35 1/2	43 7/8	4 7/8	35 1/2	46 5/8	6 1/4	34 1/2	NOTE 3

* NOTE: THICKNESS SHOWN ABOVE IS FOR CARBON STEEL 30 ksi MINIMUM YIELD STRENGTH

NOTES

1. Weamco recommends these items be made in two pieces (spacer ring and paddle blind) due to their size and weight.
2. Dimensions are based on ASME B 16.47, Series "A".
3. 26" and larger 1500# are not a published manufacturers or ASME standard.



(918) 445-1141

(800) 331-3790

Fax: (918) 445-4617

www.weamco.com

Bulletin PBS303

Bleed Rings

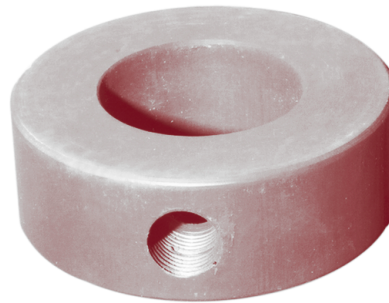
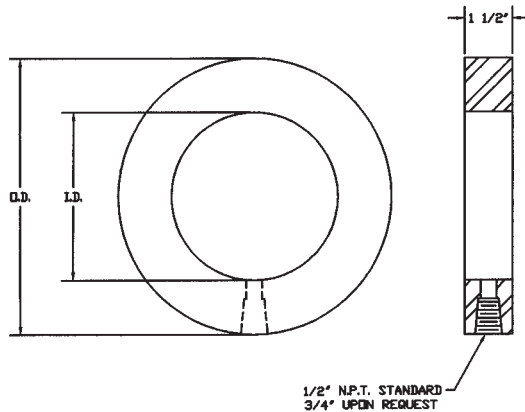

TYPE 6
Bleed Rings
RF, FF or RTJ can be furnished

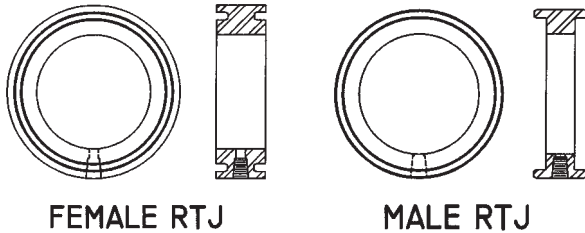

SIZE	I.D.	O.D.					
		125 # FF 150 # RF	250 # FF 300 # RF	400 # RF	600 # RF	900# RF	1500# RF
1	1 1/8	2 1/2	2 3/4	2 3/4	2 3/4	3	3
1 1/4	1 3/8	2 7/8	3 1/8	3 1/8	3 1/8	3 3/8	3 3/8
1 1/2	1 3/4	3 1/4	3 5/8	3 5/8	3 5/8	3 3/4	3 3/4
2	2 1/4	4	4 1/4	4 1/4	4 1/4	5 1/2	5 1/2
2 1/2	2 5/8	4 3/4	5	5	5	6 3/8	6 3/8
3	3 1/4	5 1/4	5 3/4	5 3/4	5 3/4	6 1/2	6 3/4
4	4 1/4	6 3/4	7	6 7/8	7 1/2	8	8 1/2
5	5 1/4	7 5/8	8 3/8	8 1/4	9 3/8	9 5/8	9 7/8
6	6 1/4	8 5/8	9 3/4	9 5/8	10 3/8	11 1/4	11
8	8 1/4	10 7/8	12	11 7/8	12 1/2	14	13 3/4
10	10 1/4	13 1/4	14 1/8	14	15 5/8	17	17
12	12 1/4	16	16 1/2	16 3/8	17 7/8	19 1/2	20 3/8

MATERIALS & SPECIFICATIONS

- Standard material: Carbon Steel ASTM A 36 or A 516 Gr 70. Almost any other steel, stainless steel or alloy steel can be supplied.
- Carbon steel rings have one coat of shop primer.
- Thickness shown is based upon ANSI Code B31.3-1987. OD, ID & RJ dimensions to fit flanges manufactured in accordance with ANSI B16.5.
- ID and OD are flame cut.
- Tolerances: ID and OD +/- 1/8".
Thickness +/- 1/16". C-C +/- 1/4.
- For special sizes and types not shown please consult the factory.

HOW TO ORDER

- Quantity
- Line size
- Flange rating
- Flange facing
- WeamcoMetric type
- Finish
- Material
- For RTJ and/or high pressure rings advise design pressure and temperature, or thickness required.



(918) 445-1141
(800) 331-3790

Fax: (918) 445-4617

www.weamco.com